

Threaded
Open Lineshaft
Column Assembly

DATE _____
DISTRIBUTOR _____

JOB _____

JOB/QUOTE # _____
UNIT QUANTITY _____

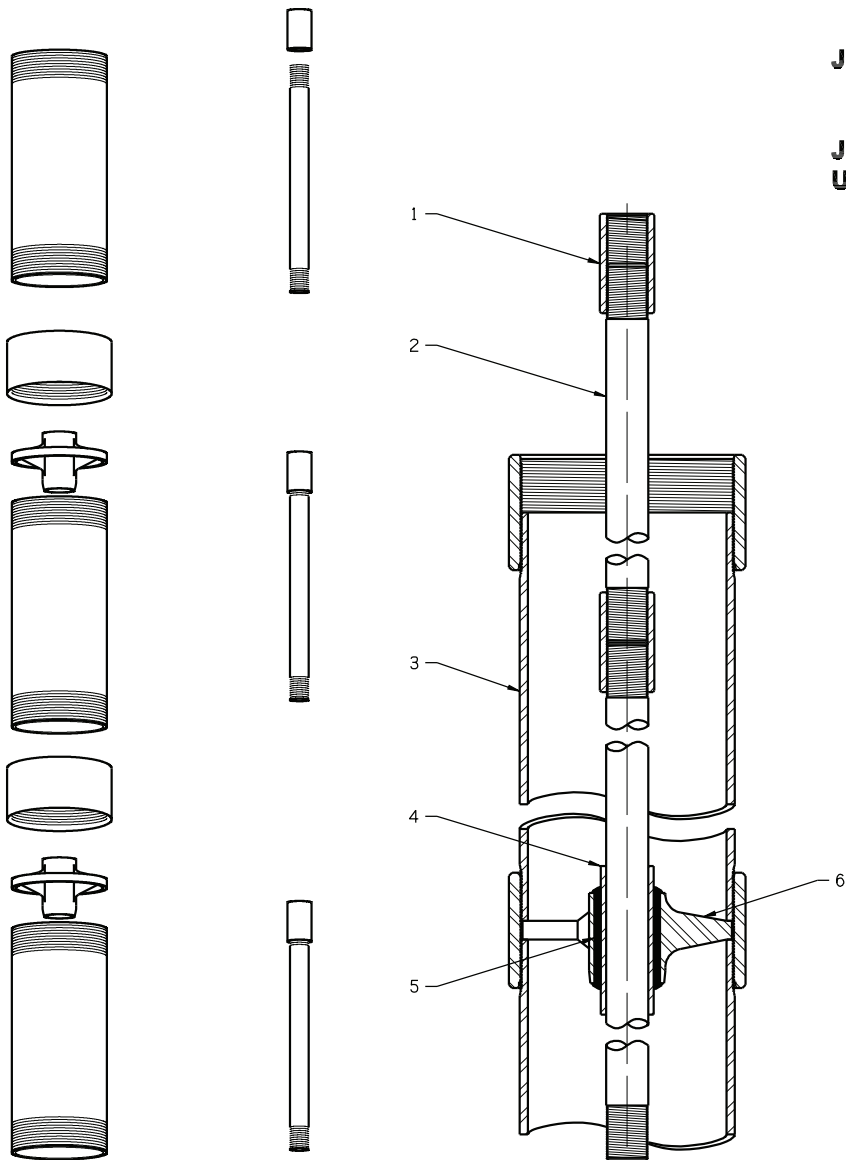

Label	Part Name	Material
1	LINE SHAFT COUPLING	ASTM A108 GRADE 1215 CR CARBON STEEL
2	LINE SHAFT	ASTM A108 GRADE 1045 CARBON STEEL
3	COLUMN PIPE (THREADED & COUPLED)	ASTM A53 GRADE B CARBON STEEL
4	SHAFT SLEEVE (OPTIONAL, NOT RECCOMENDED)	ASTM A511 GRADE 304 STAINLESS STEEL
5	LINE SHAFT BEARING	NEOPRENE
6	BEARING RETAINER (DROP IN)	ASTM A743 CF8 STAINLESS STEEL