

SIMFLO®

THE SAC DISCHARGE HEAD

SIMFLO's new SAC Discharge heads are designed for short set applications, less than 250'. While maintaining the quality and robustness found throughout our vertical turbine product line, the SAC adds an economical option to our discharge head selections.

- FOR USE IN MUNICIPAL, COMMERCIAL, INDUSTRIAL AND AGRICULTURE MARKETS
- COST EFFICIENT
- ALL DUCTILE IRON CAST
- 150# FF DISCHARGE FLANGES ONLY
- 6", 8" IN-STOCK
- 10" DESIGN COMING SOON
- FOR APPLICATIONS EXCEEDING 200HP, CONTACT FACTORY



AVAILABLE
CERTIFIED TO
NSF

Certified to
NSF/ANSI/CAN 61
& NSF/ANSI 372



THE SAC DISCHARGE HEAD

SIMFLO®

FEATURES & BENEFITS

- HEAVY DUTY LIFTING LUGS DESIGNED FOR SAFE LIFTING WITH SHACKLES (SHACKLES NOT INCLUDED)
- MACHINED FOR THREADED OR FLANGED COLUMN
- MAINTAINS LARGE INTERIOR WORKING AREA AS SHC SERIES FOR VHS AND VSS TYPE MOTORS
- UTILIZES 550 SERIES HOUSING FOR PACKING, MECHANICAL SEALS, OIL-LUBED AND WATER-FLUSH APPLICATIONS
- ADDITIONAL OFFSET BOLT HOLES FOR VARYING ORIENTATIONS OF CONDUCTION BOX
- DUAL MOTOR REGISTERS FOR 6" HEAD TO ACCEPT 10"/12" BD AND 16.5"/20"/24.5" BD MOTORS
- UV-RESISTANCE POLYCARBONATE SAFETY GUARDS
- ENGINEERED FOR NEW AND RETROFITTED INSTALLATIONS

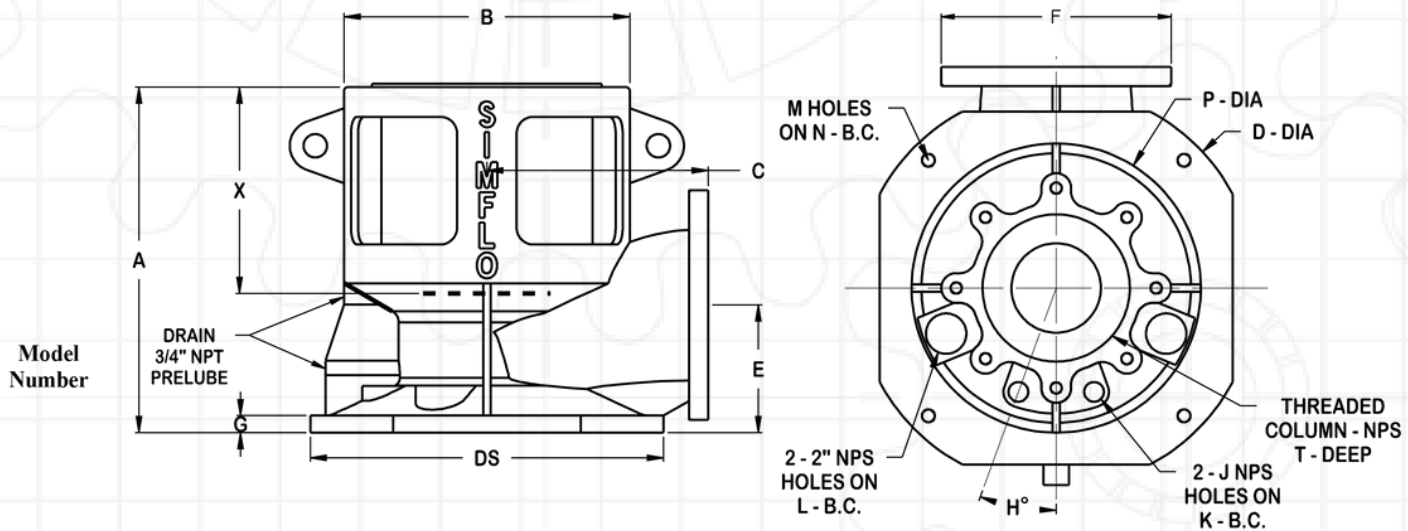

	Size	A	B	C	D	DS	E	F	G	H	J	K	L	M	N	P	T	X
SAC-6	6	18.88	16.5	12.0	23.50	20.75	6.75	11.0	1.00	20.0	3/4	10.50	11.60	(4x) .75	18.75*	14.50	1.75	11.63
SAC-8	8	20.31	16.5	13.0	23.50	20.75	7.50	13.5	1.00	20.0	1	13.00	14.00	(4x) .88	21.25	16.94	1.75	12.13
SAC-10	10	24.31	20.0	14.0	26.75	23.00	9.25	16.0	1.13	24.0	1	16.75	17.25	(4x) .88	25.00*	20.50	2.50	13.25

* SAC-6 has dual base drilling dimensions M x N - (4x) .75" holes on 21.25" B.C.
 * SAC-10 has dual base drilling dimensions M x N - (4x) .75" holes on 22.75" B.C.

Model Number	Weight [lbf]	Discharge flange	Column type	Max Operating Hanging Wt. [lbf]	Max Lifting Load [lbf]	*Setting [ft]	Clevis Size [in]	Gr. A Clevis WLL [lbf/ ea]	Gr. B Clevis WLL [lbf/ ea]
SAC-6	250	150#	Threaded / Flanged	20000	20000	250	1-1/8	19000	30000
SAC-8	290	150#	Threaded / Flanged	25000	20000	250	1-1/8	19000	30000
SAC-10	460	150#	Threaded / Flanged	30000	20000	250	1-1/8	19000	30000

